

## 1250Air - Air Assisted Bar

### Notes

If the range of the 1250 or Super 80 Bar is not sufficient it can be extended with air assistance to blow the ions to the object

- The 1250Air has all the advantages of the 1250-S Bar with the assistance of an airflow which extends the neutralisation distance up to 500mm or more, depending on the pressure used.
- It is used for blowing ionised air into a restricted area, onto a product which moves in position or onto a substantially 3-dimensional product.
- Typical applications for the 1250Air are stopping film sticking to rollers on packaging machines, neutralising the static charge on vacuum- and thermoformed packaging, keeping sensors clean and free of static, neutralising mouldings on conveyors - and many others.

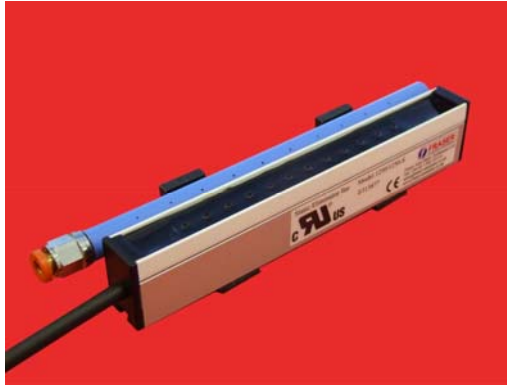

### Construction:

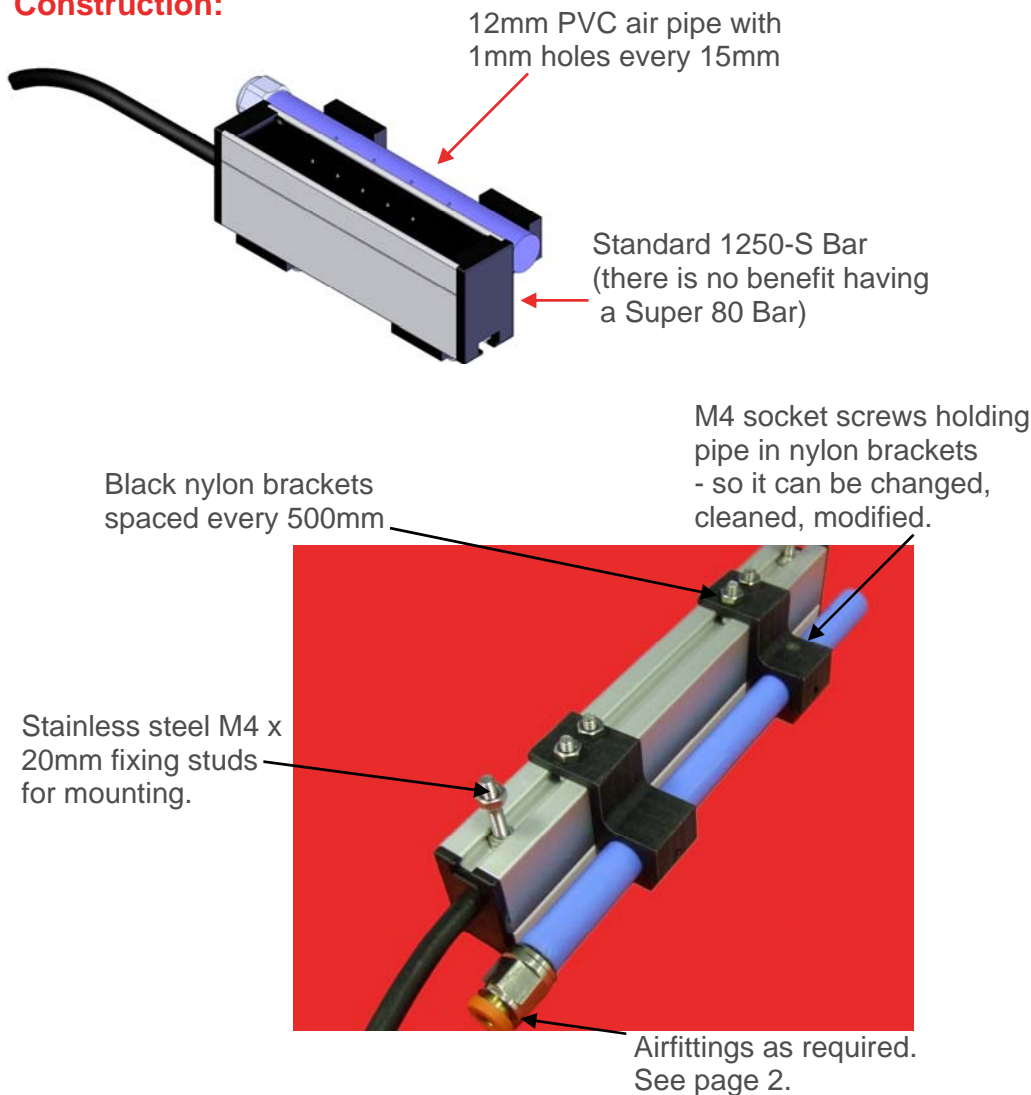

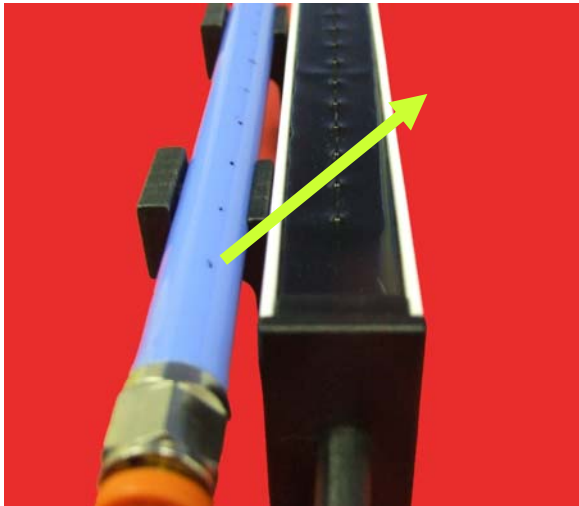

The air blows at 45° across the emitter pins, which we have found to be the most effective method of transporting the ions.

The positioning of the Bar should take this into account.

**Notes**

**General Arrangements and Dimensions**

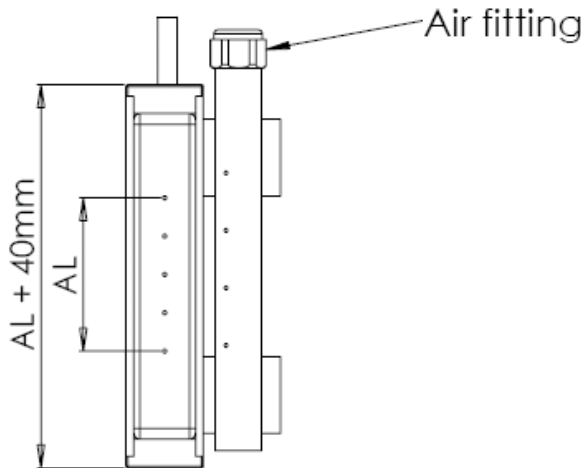
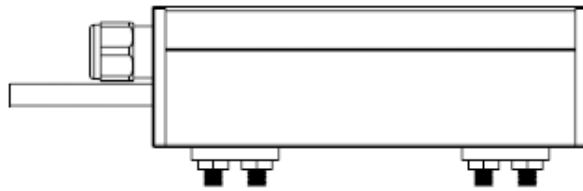
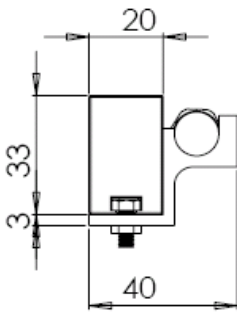

Weight:

**Air Supply:**

The compressed air should be clean and dry. The pressure required depends on the length of the Bar. A typical pressure to achieve an airflow of 2m/sec on a 500mm long 1250AB is 0.8 Bar.

The holes in the air pipe are 1mm, spaced 15mm apart. The air consumption will depend on the length of the bar and the pressure of the compressed air. The 500mm Bar mentioned above will use approx 40 lit/min at 0.8 Bar.

The standard air fitting supplied on the 1250AB depend on its length:

- 1250AB length - up to 1000mm: one 10mm push-in air fitting
- over 1000mm: one 10mm push-in air fitting at each end.

Other air fittings may be specified at time of ordering.

**Air Pressure:**

The normal operating air pressure is 0.5 - 2 Bar, depending on the length of the Bar. The maximum air pressure is 2 Bar. Please contact factory if you want to use a higher air pressure.

## Previous 1250AB

The former Model 1250AB - as in photo - is still available for special manufacture and for spares requirements.



## Notes

<b>Construction:</b>	<p>The 1250AB consists of a 1250 Bar mounted onto an aluminium bracket with an airbox.</p> <p>Dimensions: Cross-section 38mm x 44mm high. Aluminium base is 60mm longer than nominal length. Two 6mm mounting holes at each end.</p>
<b>Air supply:</b>	<p>The air supply should be regulated down to about 1-2 Bar in pressure to produce a gentle stream of ionised air.</p> <p>The 1250AB is not designed for high pressure blow-off applications - it should not be used to remove dust from objects. The maximum air pressure is 2 Bar. The 5100 Airknife or 4200 Air Nozzles should be used for dust removal.</p>
<b>Air fittings:</b>	<p>1250AB Bars have a fitting for push-in air pipes. The pipe connectors are sized as follows:</p> <p>Bars up to 1m: one connector at the cable end for a <b>10mm OD</b> push-in pipe.</p> <p>Bars over 1m to 1.3m: one connector at cable end for a <b>12mm OD</b> push-in pipe.</p> <p>Bars from 1.3m to 2.5m: one connector at each end for <b>12mm</b> push-in pipes.</p>